

The logo for iLOCK, featuring the word "iLOCK" in a white, sans-serif font. The "i" is lowercase and has a dot, while "LOCK" is uppercase. The logo is centered within a solid blue rectangular background.

User manual

contact@ilocksystems.com
www.ilocksystems.com
tel.+ (48) 61 669 06 87

technical support:
support@ilocksystems.com

Table of contents

I.	Basic informations	2
1.	Connecting the fingerprint reader and the electric lock.	2
2.	How to use fingerprint reader correctly.	2
3.	Wrong way of using the fingerprint reader.	3
II.	System startup.....	4
1.	First system startup.....	4
2.	Searching for the iLock system using the mobile app.	5
3.	Menu	6
4.	Relays visibility activation	7
5.	Adding user	9
6.	Adding fingerprints to selected user.....	10
7.	Control/Status.....	11
8.	List of occurrences	11
9.	List of users	12
10.	Settings	12
11.	Adding new readers.....	14
12.	Schedule of entrances	14
13.	Geolocation	16



I. Basic informations

1. Connecting the fingerprint reader and the electric lock

All fingerprint readers are connected by 4 wires, 2 are used for power supply of the reader and the other two for data transfer in RS-485 standard. Electric lock should be connected to one of 4 relays placed on the board of the iLock control unit. Users can find precise instructions about connections in the *Wiring Manual*.

2. How to use fingerprint reader correctly

Slide your fingertip through the reader from top to bottom. When it is done correctly, green LED on the fingerprint reader will light up.

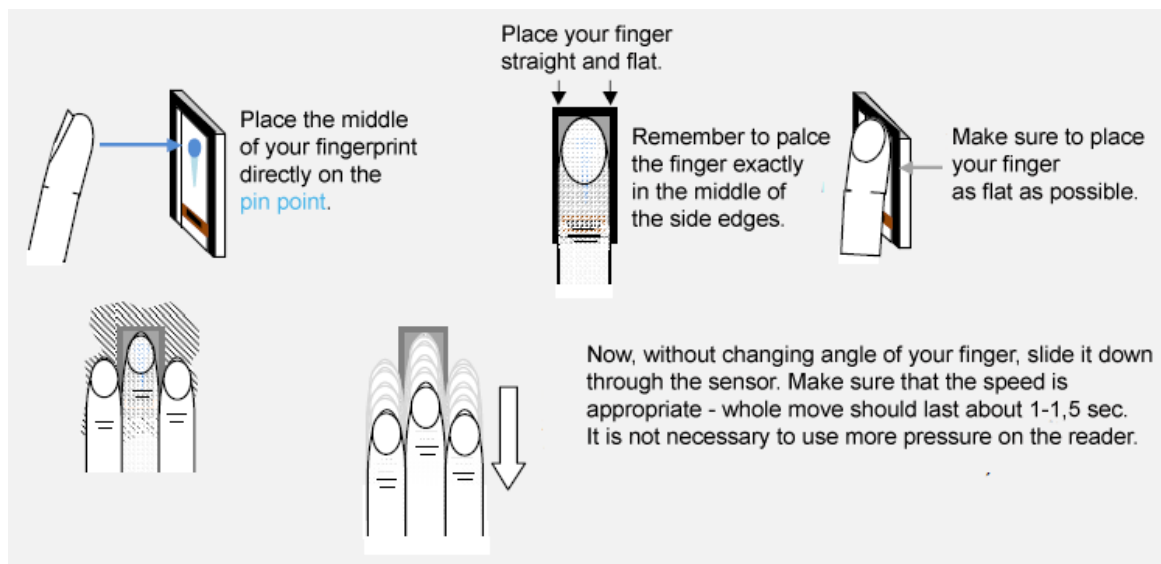

Figure 1. Hints how to use the fingerprint reader correctly.

3. Wrong way of using the fingerprint reader.

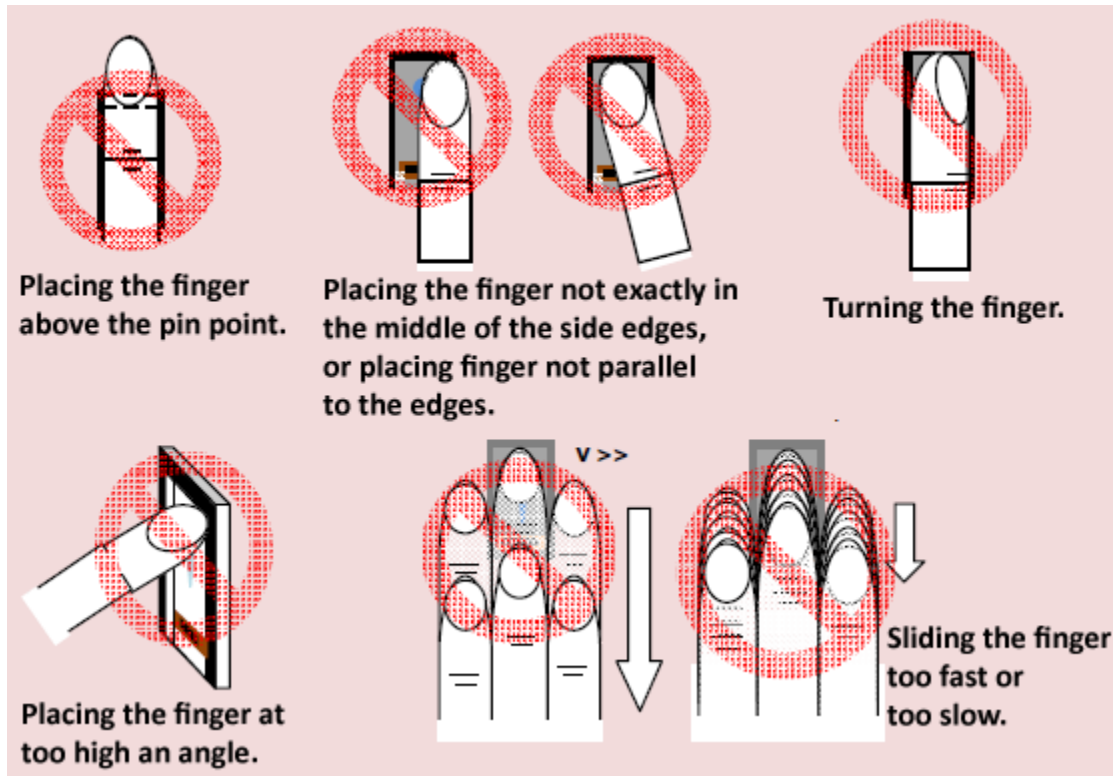

Figure 2. Actions you should avoid when using the reader.

II. System start-up

1. First system start-up

- DO NOT CONNECT ANY POWER SUPPLYS TO DEVICE UNTIL YOU MAKE SURE THAT ALL THE WIRES ARE CONNECTED TO ILOCK CONTROL UNIT!
- Connect iLOCK to the router (LAN input) by FTP/UTP cat. 5e cable. **WARNING! The black socket is used to connect readers. Connecting the router to this socket may damage the device! For more information check the wiring instructions available at www.ilocksystems.com**
- Check all the connections between fingerprint reader, electric lock, reel switch, LAN and iLOCK control unit. **WARNING! The iLOCK systems needs a service restart of the device for proper operation, which is automatically performed everyday at 01:30 a.m. This may cause a short brake in the operation of the system.**
- If all of the above have been done correctly you can connect the power supply to the device.

Download **iLock System** app from **App Store** if you are using iOS or from **Google Play** for android devices. Search for: “**iLock System**”.

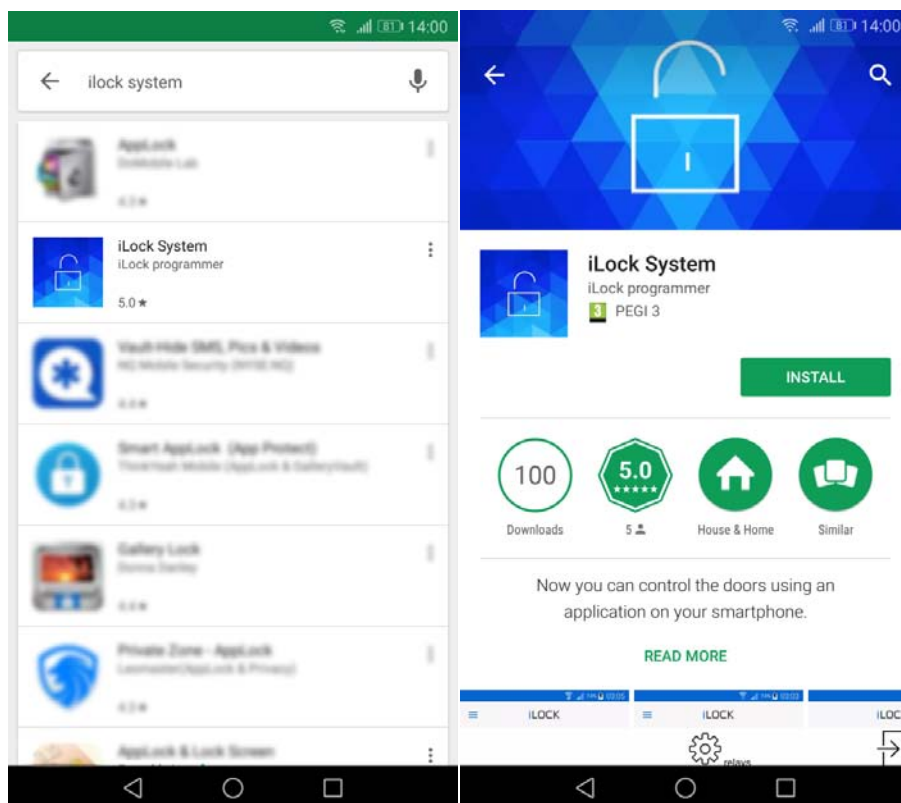

Figure 3. Searching for the iLock app in the Google Play.

2. Searching for the iLOCK system using the mobile app

ATTENTION: ILOCK CONTROL UNIT NEEDS ABOUT 180 SECONDS FOR COMPLETE START-UP. AFTER THAT TAKE THE NEXT STEPS

- To search for a system, install **iLock System** app on your device connected to a local computer network, such as a smartphone or tablet connected to WiFi
- Make sure your device with iLock System app is connected to the same WiFi as iLOCK control unit.
- Turn on the app and press the „Search for system” button.
- Press the found system and enter the initial login (admin) and password (admin). **ATTENTION: To log in by more than one device you should add proper number of users. For security reasons, the initial login details should be changed immediately. During first log in, the application will go to the password change screen and add an email address).**
- Push the "Log in" button.
- Congratulations. You are connected with the iLock system.



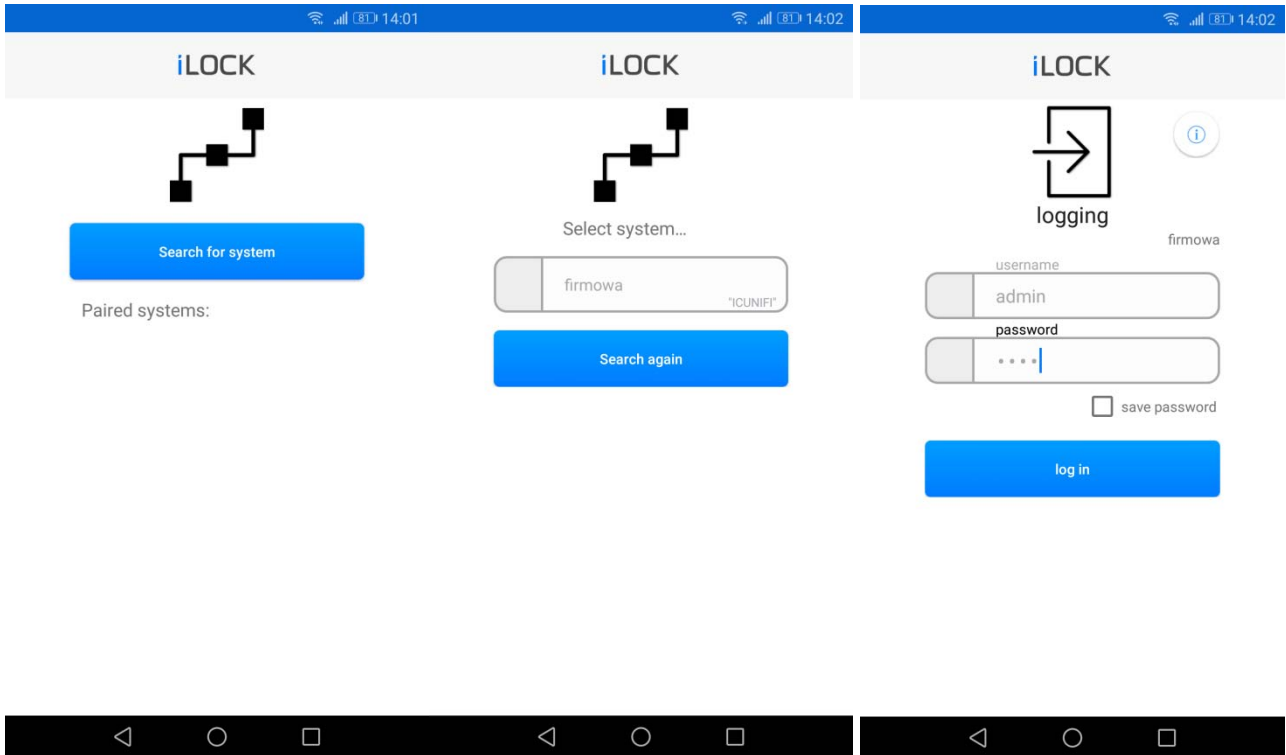

Figure 4. First login to the iLOCK System

3. Menu

To open the Menu click on the icon with three blue stripes which is placed on the bar with iLOCK logo (figure 5).

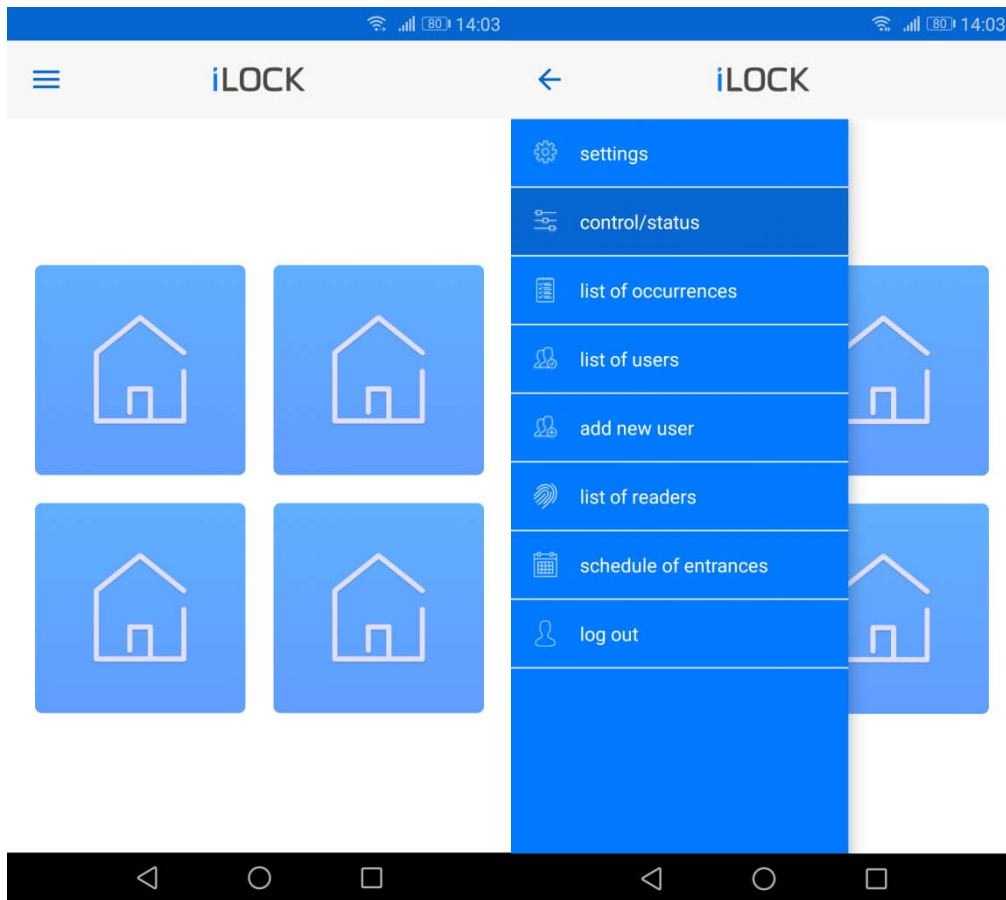

Figure 5. Opening menu in the iLOCK System application.

4. Relays visibility activation

At the first launch of the iLock application and control unit, all buttons on the main application screen are off, which means that no gates (relays) have been activated. To activate them choose „**settings**” and then „**relays**” from menu.

In the “relays” menu except of available options like e.g. name changing, we can activate gate by clicking a tick mark beside “**activity gate**” label (figure below).

After you have completed the instructions above, on the main application screen (control/status) you will be able to control the gate which you have configured (selected relays).

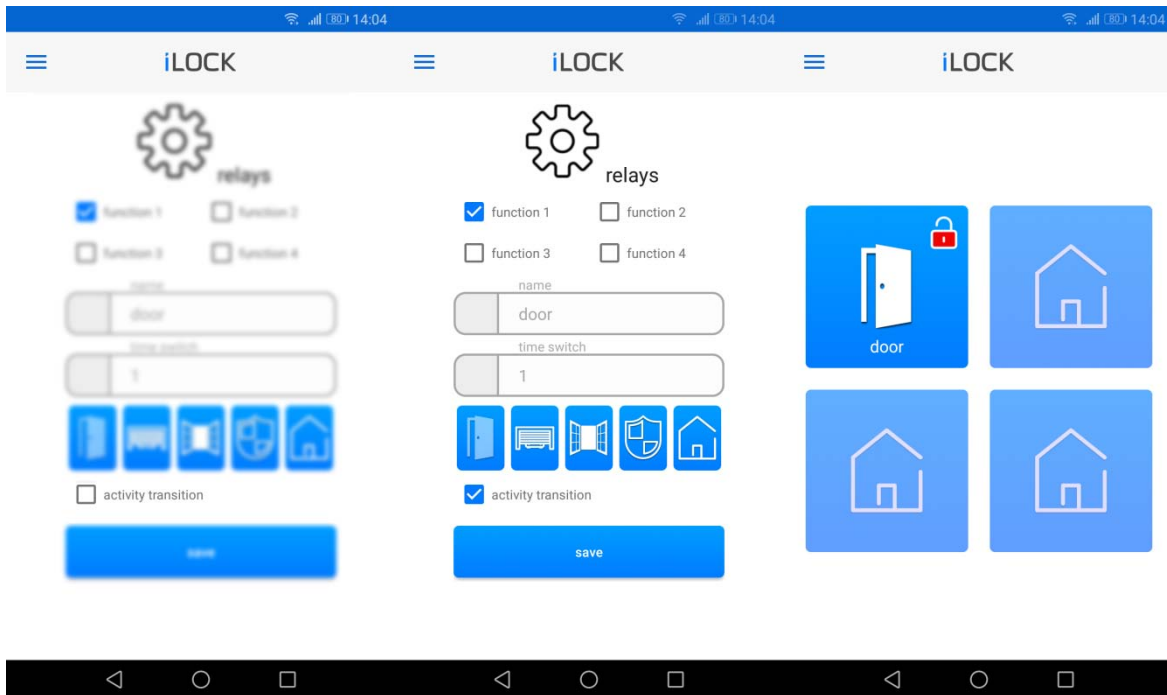

Figure 6. Activating gates in iLOCK System

5. Adding user

In “add new user” window you can add user information and determine access level of the user.

Logging – allows to log in to the app, but without access to: „Add new user”, „List of users” and „settings”

Administrator – has access to every options in the app.
ATTENTION: administrator can delete another users.

Entrance notifications – If administrator will select this option when adding specific user, he would receive e-mail notification of any occurrences that this user will make.

ATTENTION: If you are using iLock app on the three different devices at the same time you should create exact number of users in the system (e.g. 2 smartphones + tablet = 3 users).

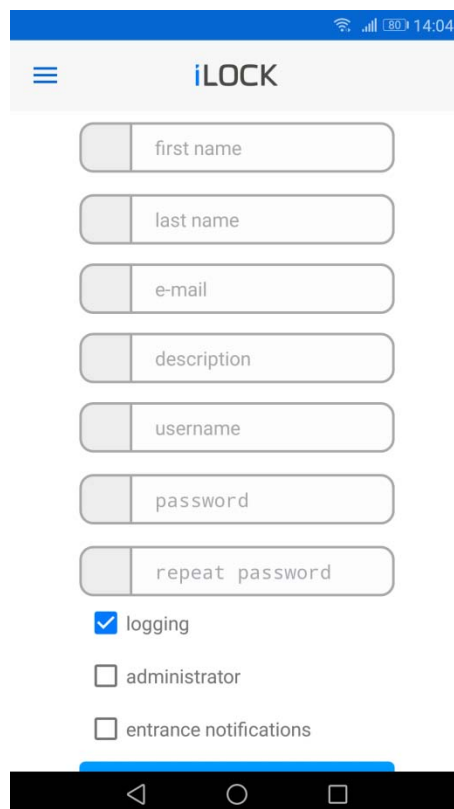

The screenshot shows the 'Add new user' form in the iLOCK app. At the top, there is a blue header with the iLOCK logo and a hamburger menu icon. Below the header, there are seven input fields: 'first name', 'last name', 'e-mail', 'description', 'username', 'password', and 'repeat password'. Below the input fields, there are three checkboxes: 'logging' (checked), 'administrator', and 'entrance notifications'. The bottom of the screen shows the Android navigation bar with back, home, and recent apps buttons.

Figure 7. Adding user in iLOCK System application.

NOTE: If iLOCK system is simultaneously using by eg 3 devices (2 smartphones + tablet), create the same number of users in the system - 3 users, by clicking on the "add user" tab in the menu

6. Adding fingerprints to selected user.

To load fingerprints press the "modify fingers" button, choose which finger you want to scan then press "add finger" button. When the scanning ends you can select which functions can be activated by loaded fingerprint (select access menu). Then click "save" button.

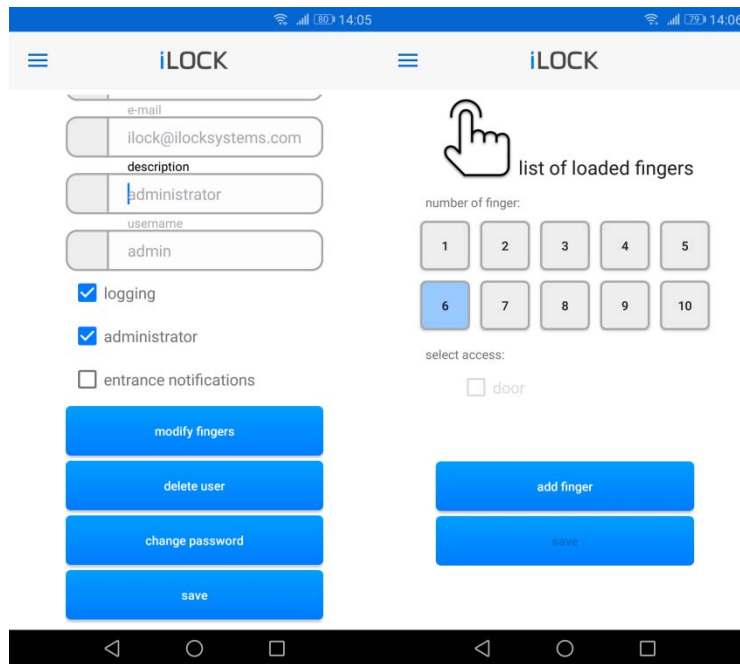

Figure 8. Loading fingers to the iLOCK System

7. Control/Status

By entering the menu in **Control/Status** we have a preview of the buttons and sensors connected to the device. A closed padlock symbolizes a closed system (e.g. closed door).

Names and icons can be modified in the tab **“settings”** -> **“relays”**

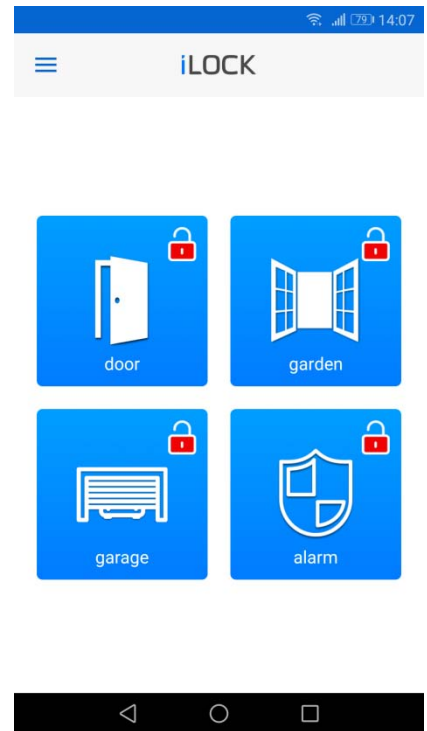

Figure 9. Status screen.

8. List of occurrences

In the list of occurrences, we have access to the iLock history. We see who used the iLock, whether it was a remote opening or with a fingerprint scan. The number of finger used is also given.

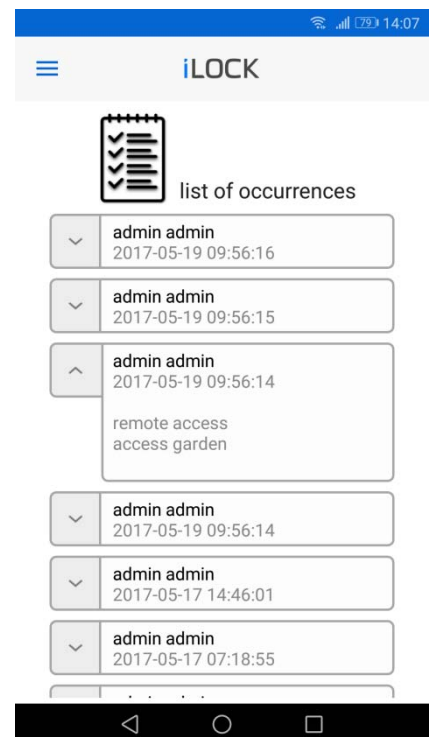

Figure 10. List of occurrences.



9. List of users

All available users are here. To view detailed information please click on the user. In the window (window in subsection 5), which appears, you can perform 4 actions (buttons):

- **Modify fingers** - you can add new fingers and select which actions are related to loaded fingers.
- **Delete user** – It allows you to delete specific user.
- **Change password** – After choosing this option you can create a new password.
- **Save** – saving changes.

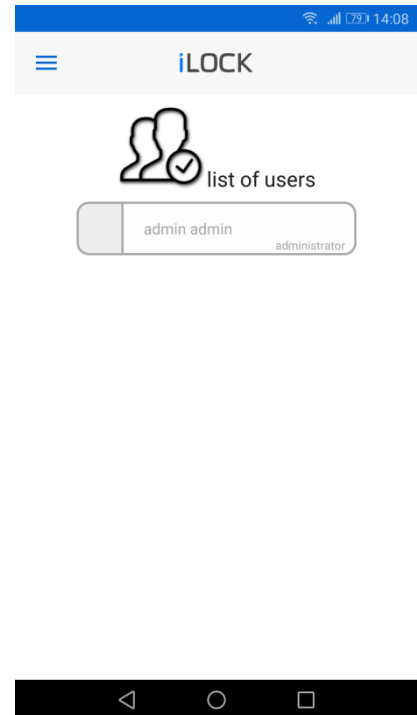

Figure 11. List of users.

10. Settings

- **Relays** – this submenu allows you to modify the name of the relay, the length of time it is on, the icon that will be displayed in the main menu, and the determination of the gate activity. After making changes, press the "save" button.
- **Change system name** – Change the system name which is visible on the log on.
- **Notification language** – Change email notification language
- **Notification time** – Change the time after which a notification is sent if the gate is too long open

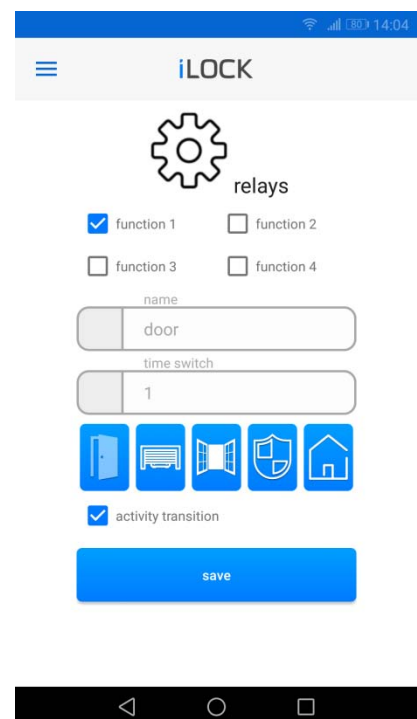

Figure 12. Gates settings.



- **System time** – Submenu allows you to check and update system time.
- **Backup** – Create and import backup settings - use in the event of failure of the control unit and exchange for a new one.
- **Reset readers**
- **Reset system** – The system restarts about 180 seconds
- **Clean system** – deletes all users and the fingerprints from the readers

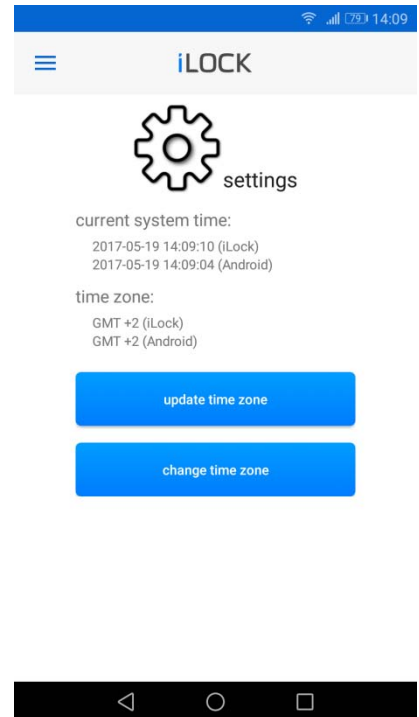

Figure 13. Time settings.

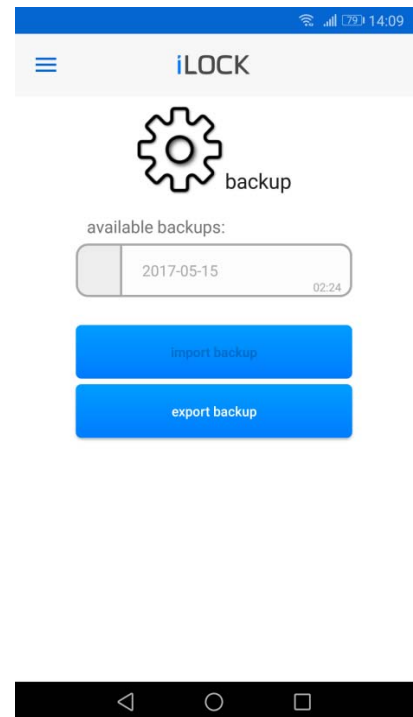

Figure 14. Backup.

11. Adding new readers

From the drop-down menu, select "reader list", then click "search readers".

If no reader is detected, check the cable connection. The reader, when connected to the iLock, should light up with a blue LED.

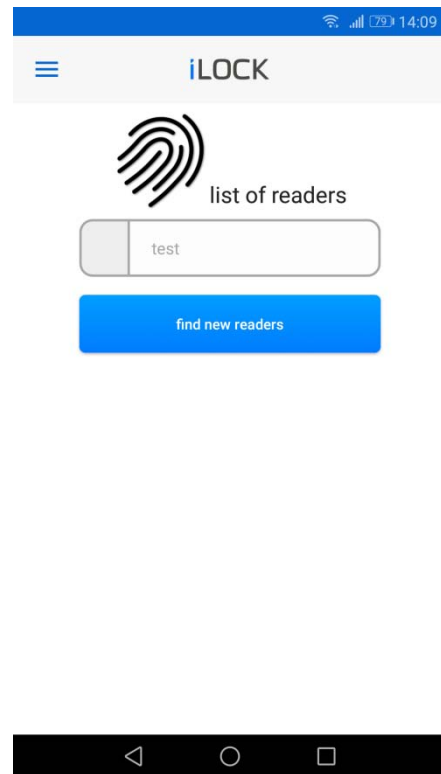

Figure 15. Readers finding.

12. Schedule of entrances

UWAGA: Adding a schedule will make opening the door impossible for users who are not added to any schedule.

When you add a schedule, you need to assign a schedule to a specific user or reader.

- **Add** – add schedule to user or reader. The reader's schedule has the higher priority.
- **Edit** – change parameters of already created schedule.
- **Assign** – assign a schedule to the user.

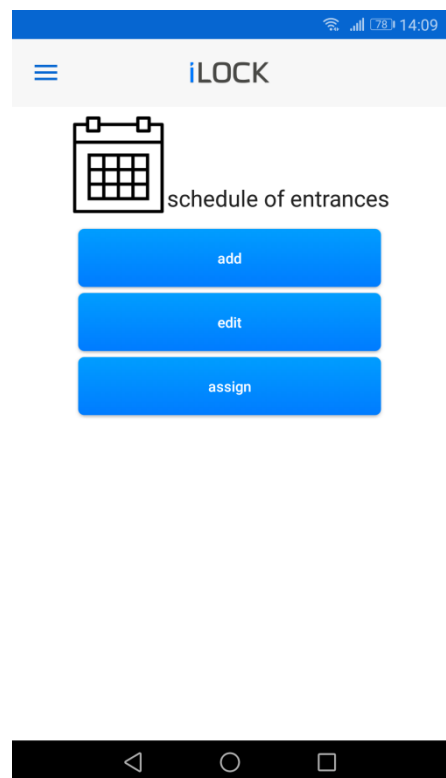

Figure 16. Schedule of entrances.



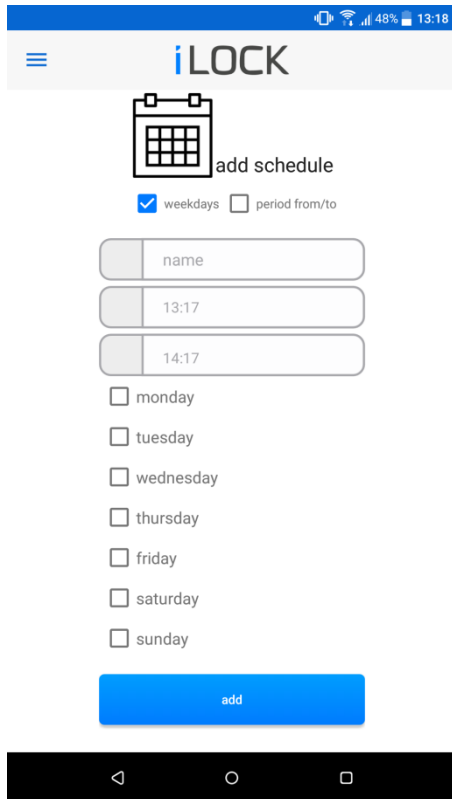

Figure 17. Schedule adding.

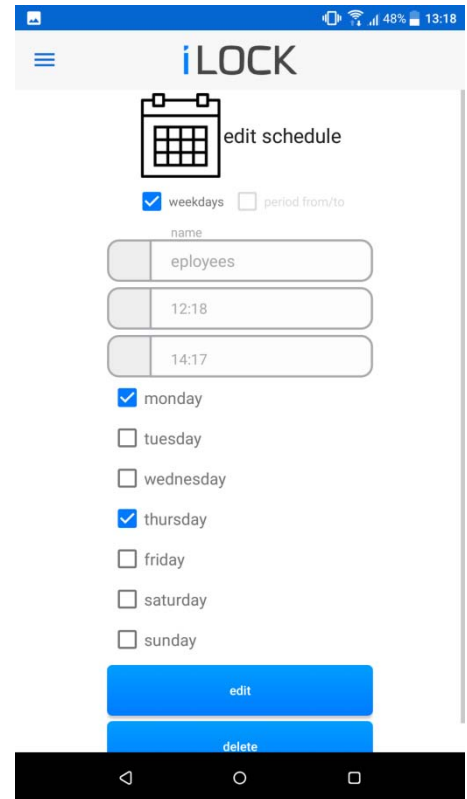

Figure 18. Schedule editing.

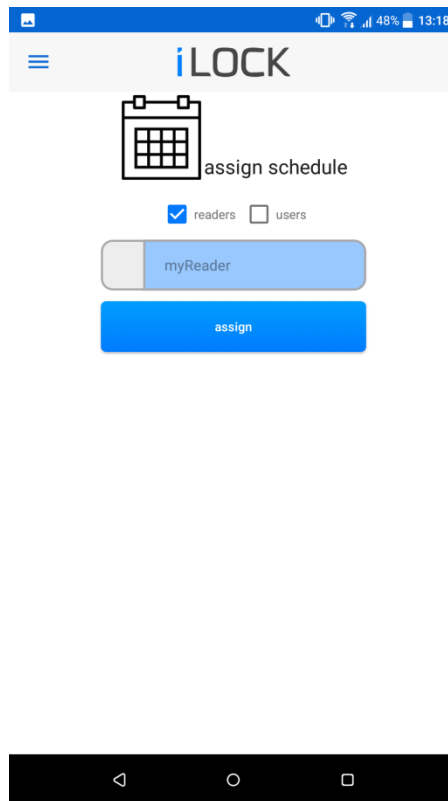

Figure 19. Schedule assigning.

13. Geolocation

WARNING! Geolocation function is used to increase iLOCK System user comfort, however it requires caution. Automatic gate opening in certain situations may negatively influence in safety. User is activating geolocation function on his own. Using the geolocation system may result in increased battery consumption of the mobile device. In order for the function to work, it is necessary to have a GPS module in the device and to enable the device location function.

Before proceeding to the further configuration of the geolocation service, the application should be allowed to access location information of the given device. It is necessary to accept message informing about possible side effects resulting from using the geolocation function.

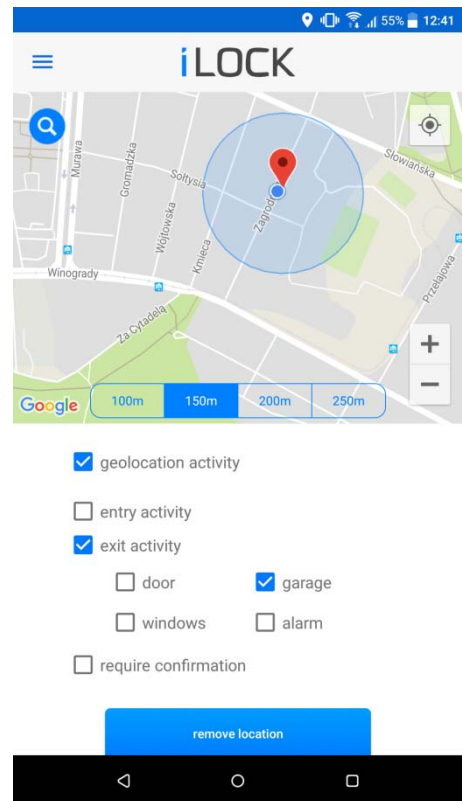

Figure 20. Geolocation in iLOCK System

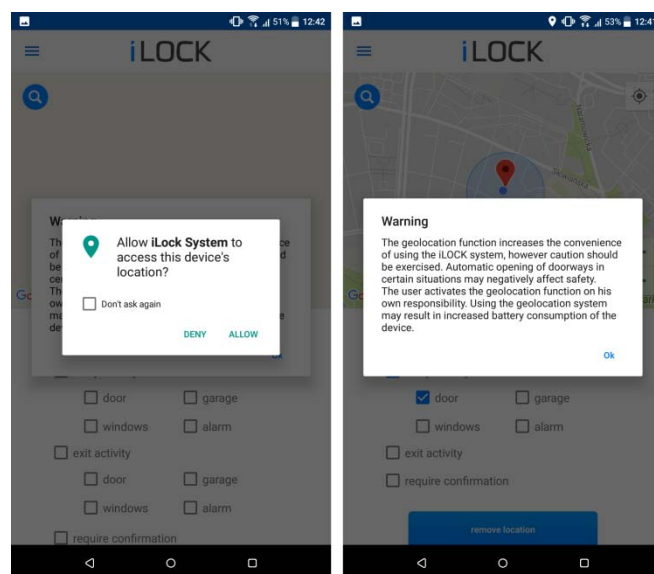

Figure 21. Accepting for using geolocation function

For one iLOCK System it is possible to set only one geolocation area. The mobile application can analyze the position of the device relative to the set area. There are two available reactions: entering the selected area and leaving the selected area. For both types of events, it is possible to assign different sets of gates in the mobile application that will be active when the area border is crossed.

To set the geolocation area for the iLOCK system, select "**geolocation**" from the drop-down menu. On the available map, you can select a point or use a search (blue icon in the upper left corner of the map). The selected point should appear on the map, then select the radius of the area. According to the expectations, select the activity options for the geolocation function for the system, gates enabled when entering the area, gates enabled when leaving the area and the need to confirm switching.

If the confirmation of activation has been selected, then when the border crossing area event is detected, a notification will be sent to the user with the necessity to confirm the action (activating gates). If the confirmation of switching was not selected, the gates will be activated automatically.

The above operations relate to the assignment of a point to the system. In order for the iLock System mobile application to track our location, you must assign it ("**assign device**" button). It is possible for one user to have active geolocation on only one device. One device can support geolocation only for one user (last logged in).

WARNING! The geolocation function needs full access to the device's location and internet connection, which is why some devices may have problems with the function while simultaneously making phone calls and using the Application.

WARNING! After rebooting the device, the geolocation in the device should be activated again (after entering the geolocation screen, press the save point or assign the device -> activate).