

Differential pressure transmitters with active output

The pressure sensor / differential pressure sensor PREMASGARD® SHD-652 is used for pressure measurement in gaseous and liquid media. It converts the measurand into standard signals of 0-10 V. Process connection is 2 x G1 / 8" straight internal pipe thread. PREMASGARD® SHD-652 differential pressure transmitters are applied in piping and hydraulic systems, in mechanical and plant engineering as well as in building automation. **Not applicable for ammonia and Freon!**

SHD 652



TECHNICAL DATA:

- Power supply:..... 24V AC (+15% / -10%)
20-30V DC (optional)
- Measuring ranges:..... see table
- Output signal:..... 0-10 V, 3-wire connection
- Electrical connection:..... 0.25 - 1.5 mm²
- Pressure connection:..... G1 / 8" straight internal pipe thread
- Type of pressure:..... differential pressure
- Measuring principle:..... Hall sensor
- Medium:..... liquid or gaseous
- Temperature of medium:..... -10 ... +80 °C
- Ambient temperature:..... -25 ... +60 °C
- Mounting:..... installation arbitrary, membrane position vertical,
pressure connection downward
- Enclosure:..... anodised aluminium
- Dimensions:..... 73 x 87 x 65 mm
- Connecting head:..... plastic, PG9
- Medium contacting parts:..... aluminium, membrane NBR
(incomplete, see datasheet)
- Load changes:..... < 10 Hz
- Response time:..... < 5 ms
- Class:..... linearity ± 1.5%
hysteresis ± 1.5%
- Total error:..... < 3 %
- Overload range:..... see table
- Bursting pressure:..... 30 bar
- Insulating resistance:..... ≥ 100 MOhm, at 20 °C (500V DC)
- Protection class:..... III (according to EN 60730)
- Protection type:..... IP 65 (according to EN 60529) with cover mounted
- Standards:..... CE conformity, electromagnetic compatibility
according to EN 61326 + A1 + A2,
EMC directive 2004 / 108 / EC

Dimensional drawing

SHD 652

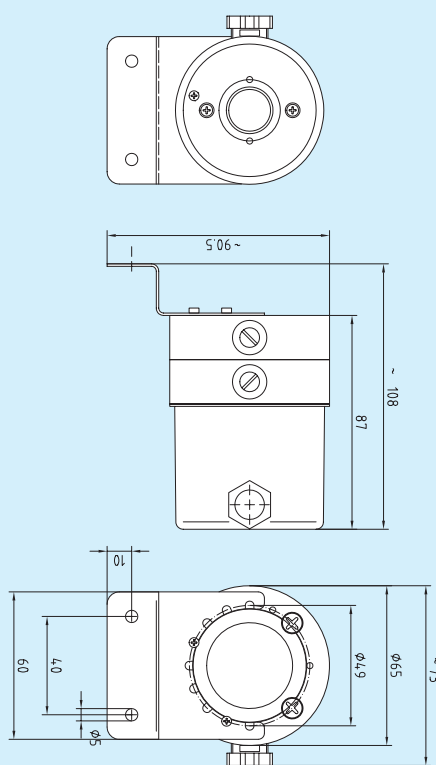

Connecting diagram SHD 652

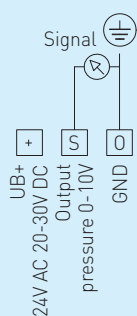

Dimensional drawing SHD 652 Mounting angle

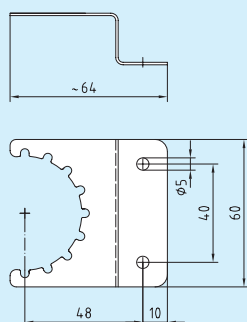

PREMASGARD® SHD 652, including mounting angle

Type/WG1	Measuring Range	Max. Operating Pressure	Output
SHD 652 - 90011	5 kPa (0...50 mbar)	10 bar	0-10V
SHD 652 - 91011	10 kPa (0...100 mbar)	10 bar	0-10V
SHD 652 - 92011	20 kPa (0...200 mbar)	10 bar	0-10V
SHD 652 - 93011	50 kPa (0...500 mbar)	20 bar	0-10V
SHD 652 - 94011	100 kPa (0...1000 mbar)	20 bar	0-10V