

Brief installation instructions

CasaConnect KNX Control Center

Article number 71200



The manual with additional information about commissioning, functions and operation of the control center **CasaConnect KNX** can be downloaded from www.elsner-elektronik.de in the menu area "Service/Downloads".

0.1. Installation notes

Installation, testing, operational start-up and troubleshooting should only be performed by an electrician.

CAUTION! Live voltage!
There are unprotected live components inside the device.

- National legal regulations are to be followed.
- Ensure that all lines to be assembled are free of voltage and take precautions against accidental switching on.
- Do not use the device if it is damaged.
- Take the device or system out of service and secure it against unintentional use, if it can be assumed, that risk-free operation is no longer guaranteed.

The device is only to be used for the intended purpose described in this manual. Any improper modification or failure to follow the operating instructions voids any and all warranty and guarantee claims.

After unpacking the device, check it immediately for possible mechanical damage. If it has been damaged in transport, inform the supplier immediately.

The device may only be used as a fixed-site installation; that means only when assembled and after conclusion of all installation and operational start-up tasks and only in the surroundings designated for it.

Elsner Elektronik is not liable for any changes in norms and standards which may occur after publication of these operating instructions.

0.2. Preparing the installation location

The device may only be installed and operated in dry indoor rooms. Avoid condensation.

0.3. Preparing the control unit

The **CasaConnect KNX** can be installed in 2 standard sockets, however, a double socket has more space for the cables.

The **CasaConnect KNX** is delivered assembled. The device, which comprises the display unit and support plant, therefore has to be dismantled. After installation and connection, the device is reassembled in the reverse order.

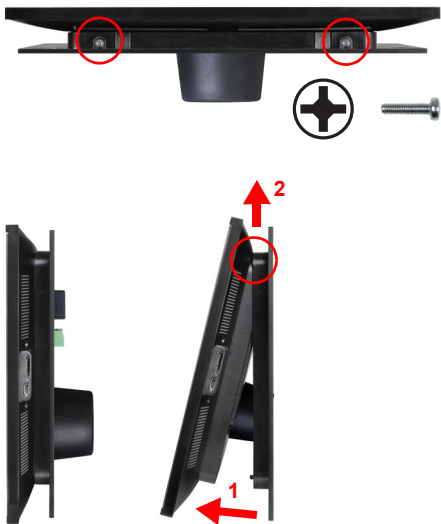

Step 1 Display from below
The display unit is screwed to the support plate from below. Loosen the screws.

Step 2 Display from the side
Pull the display unit forward from the lower area by simultaneously pushing from below against the two catches, and hang it from the top edge.

The display can now be removed.



Display from above
Detail view: Notices and mounts of the display unit.

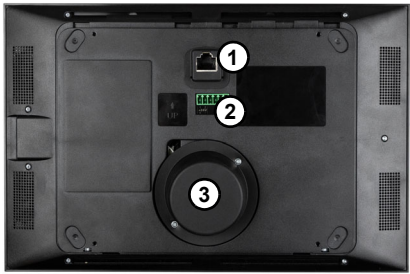

Display rear
1 Network cable connection (optional)
2 KNX bus and auxiliary voltage connection
3 Loudspeaker with cover

When handling the display unit, take care with the loudspeaker (3). This is magnetic and connected with sensitive cables.

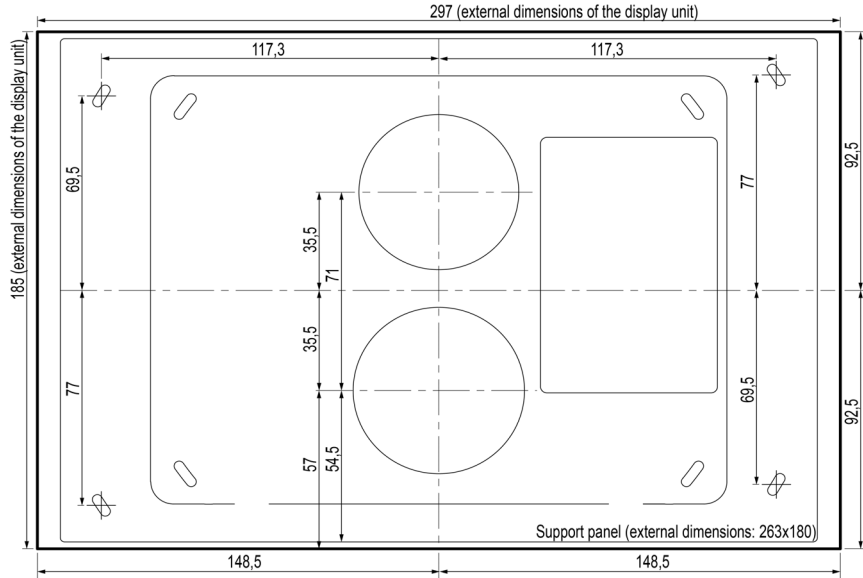

All dimensions in mm

Step 3 Support plate as drill template

Use the support panel as a drill template. Place it over the position of the two standard switch boxes and mark the 4 drill holes for the 4 fixing screws.

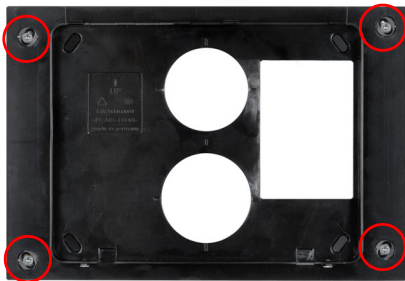

Step 4 Support panel on wall
Screw the support plate to the wall using 4 screws. Use suitable fastening material for the base. 4 countersunk cross-slot screws (WN57, 3.5x35mm, galvanised) with matching anchors (S5) are supplied.

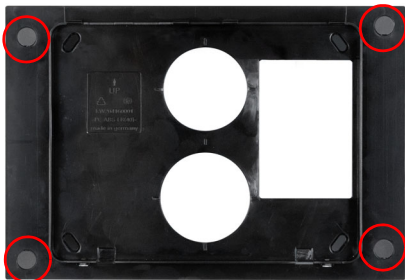

After commissioning the screws should be covered with the supplied covers.

For maintenance, the covers can be carefully levered out in order to gain access to the screws.

Pass all connection cables through the top socket and the top opening of the support plate.

0.4. Connection and installation of the control unit



Display rear connections
Connect KNX (red + / black -) and 24 V DC auxiliary voltage (yellow + / white -). For a cable network connection, connect the network cable to the Ethernet socket.

1	Auxiliary voltage	+	yellow
2	Auxiliary voltage	-	white
5	KNX	+	red
6	KNX	-	black

Cover the support plate screw connection with the caps provided.
Hang the display unit at the top of the support plate and fold it down (step 2). The display snaps in but also has to be secured with 2 screws (step 1).

0.5. Technical data, control center CasaConnect KNX

Casing	Glass, plastic
Colour	black
Assembly	Flush-mounted (in 2 standard switch sockets or a double socket)
Protection class	IP20
Size	Display front approx. 279 × 185 (W × H, mm), Installation depth approx. 30 mm
Display resolution	1280 × 800 pixels
Weight	approx. 1.2 kg
Ambient temperature	Operation 0...+55°C, Storage -30...+70°C
Ambient humidity	5...95% rF, avoid condensation
Operating voltage	20...32 V DC. A suitable mains unit can be purchased from Elsner Elektronik.
Bus current	approx. 10 mA
Power consumption	Readiness max. 17 W
Data output / Bus communication	KNX +/- bus plug terminals
Group addresses	max. 2000
Allocations	max. 2000
Communication objects	1979

The product conforms to the conditions of the EU Directives.